

HEATER CONNECTION KIT PP

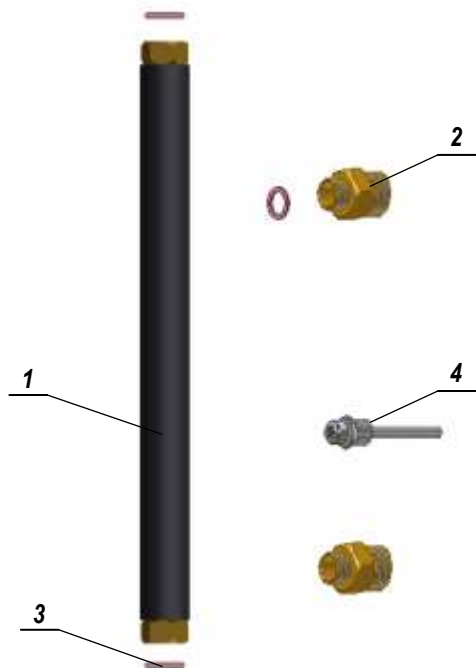

Fig. 1



Fig. 2

1. Table of elements (Fig. 1):

No.	Description of element	Article no.	Quantity
1	Flexible connector	50.11.02	1 ea.
2	Reduction nipple 1" / 3/4"	80.10.22	2 ea.
3	Gasket S 24/18	40.41.01	3 ea.
4	Casing of temperature sensor. 1/2"	50.41.00	1 ea.

2. Function

The connection kit PP is designed for quick and easy connecting of a heater to control and pump assembly.

3. Assembling (Fig. 2)

Mounting positions of the control and pump assembly should be assigned close to the heater keeping in mind that the length of flexible connection (1) is limited.

Further assembling operations:

1. Screw on Reduction nipple 1" / 3/4" (2) to stub pipes placed on the bottom coil piping of the heater.
2. Mount flexible connection.
3. Screw casing of temperature sensors (4) to stub pipes at bottom coil piping.