

HEATER CONNECTION KIT PC

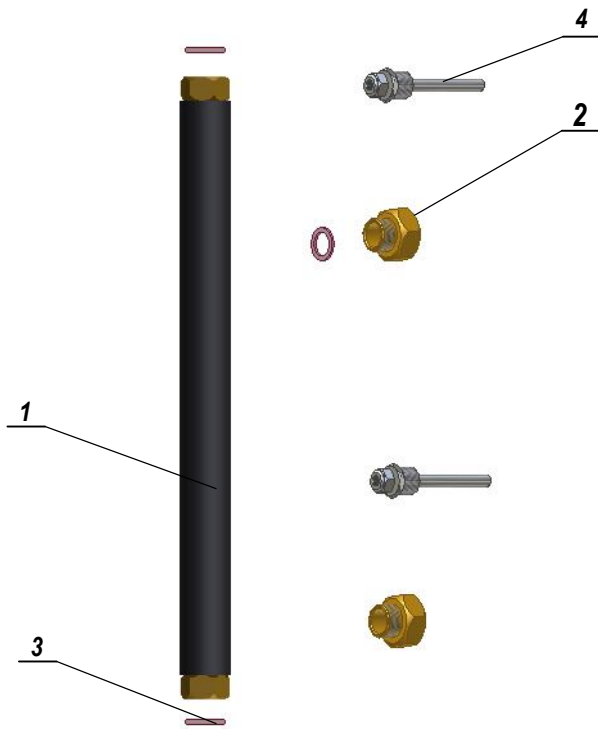

Fig. 1



Fig. 2

1. Table of elements (Fig. 1):

No.	Description of element	Article no.	Quantity
1	Flexible connector	50.11.02	1 ea.
2	Reducer 1" / 3/4"	80.10.21	2 ea.
3	Gasket S 24/18	40.41.01	3 ea.
4	Casing of temperature sensor. 3/4"	50.31.00	2 ea.

2. Function

The connection kit PC is designed for quick and easy connecting of a heater to control and pump assembly.

3. Assembling (Fig. 2)

Mounting positions of the control and pump assembly should be assigned close to the heater keeping in mind that the length of flexible connection (1) is limited.

Further assembling operations:

1. Screw on reducer (2) to stub pipes placed on the bottom coil piping of the heater.
 2. Mount flexible connection.
 3. Screw casings of temperature sensors (4) to stub pipes at bottom and top coil piping.
1. untere- und obere- Heitzshlange.